

CD Box RS2 T Firmware Update

01-2020



Programming of STM processor of CD BOX RS2 T to upgrade Firmware

1. Turn off the unit and unplug the power adaptor.
2. Unmount top cover of CD box.

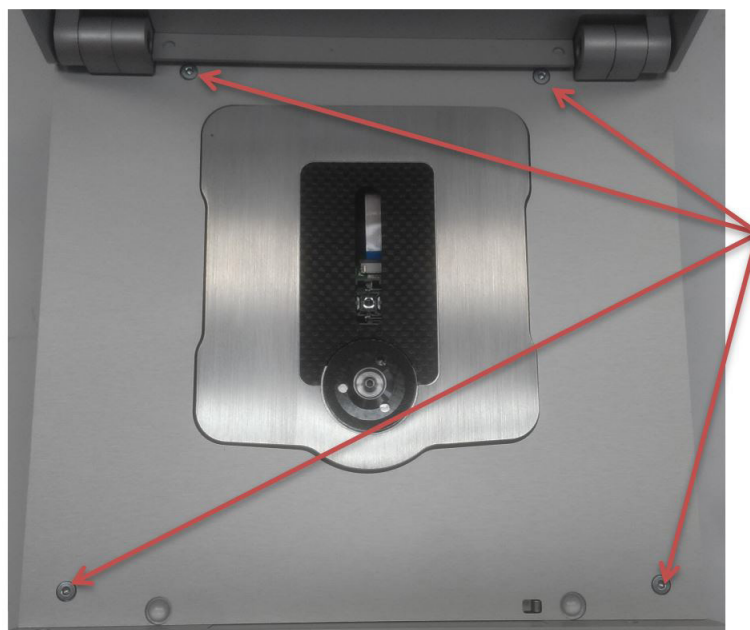

3. Plug in power adaptor.
4. Connect STM programmer (STM32F0-Discovery or ST LINK / V2 ISOL) to the dedicated connector inside CD Box, follow table and pictures below:

Pin CD Box RS2 T		STM32F0- Discovery	ST LINK / V2 ISOL
1	3V3	1	1
2	SWCLK	2	9
3	GND	3	3
4	SWDIO	4	7
5	NRST	5	15

Pin assignment on STM32F0-Discovery:



Pin assignment on ST Link V2 ISOL:



Pin assignment on Stream Box RS2 T:

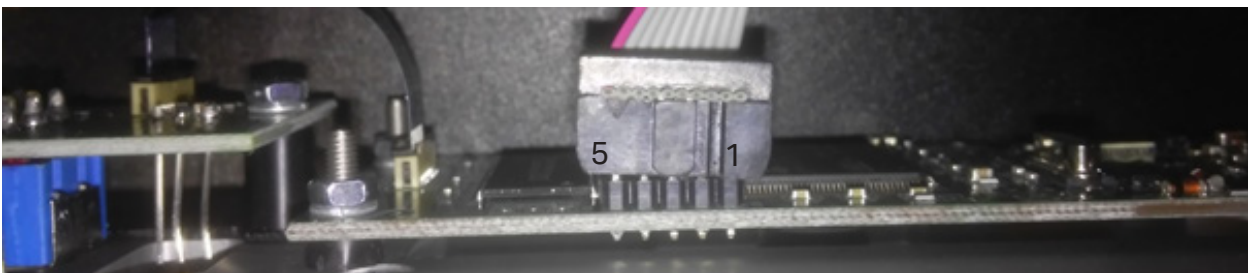
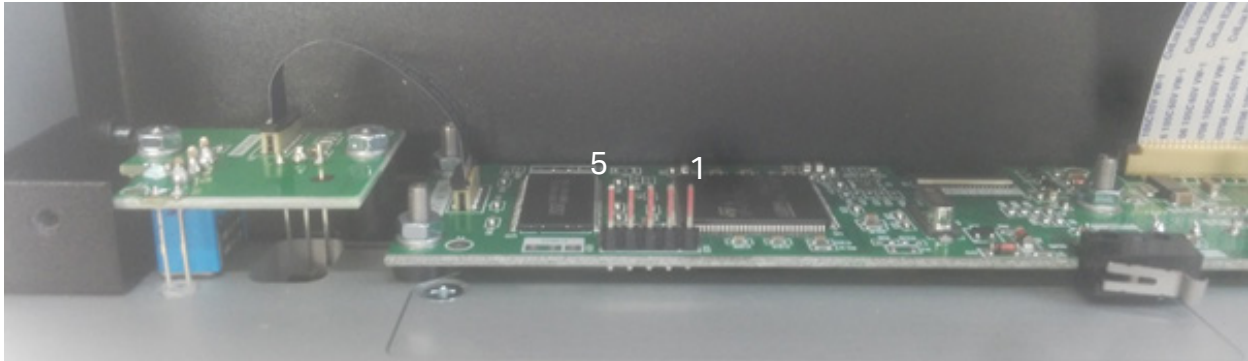

5. Download and install the following USB Driver on your PC:

https://www.st.com/content/st_com/en/products/development-tools/software-development-tools/stm32-software-development-tools/stm32-utilities/stsw-link009.html
(Account creation on the website may be necessary)

6. Download and install the following Firmware Flashing Tool on your PC:

<https://www.st.com/en/development-tools/stsw-link004.html>
(Account creation on the website may be necessary)

7. Use supplied script (write_flash in CD Box RS2T_FW_01_08.zip) with new fw to update STM processor. Follow instructions on screen. See Screenshots on the next page.

```
C:\WINDOWS\system32\cmd.exe

Pripoj CD Box k 5 pinovemu prog STM32 procesora !
Press any key to continue . . .

C:\WINDOWS\system32\cmd.exe

Pripoj CD Box k 5 pinovemu prog STM32 procesora !
Press any key to continue . . .
STM32 ST-LINK CLI v3.1.0.0
STM32 ST-LINK Command Line Interface

ST-LINK SN : 36FF6F064D59303651361443
ST-LINK Firmware version : V2J28S0
Connected via SWD.
SWD Frequency = 4000K.
Target voltage = 2.9 V.
Connection mode : Connect Under Reset.
Device ID:0x419
Device flash Size : 2048 Kbytes
Device family :STM32F42xxx/F43xxx

Loading file...
Flash Programming:
  File : CDBOX_01_07.hex
  Address : 0x08000000
Memory programming... 100%
Memory programmed in 23s and 437ms.
Verification...OK
Programming Complete.
Programmed memory Checksum: 0x04D0AE82

Pripoj CD Box k 5 pinovemu prog STM32 procesora !
Press any key to continue . . .
```

6. Once finished, unplug programmer and power adaptor.
7. Turn the unit on.
8. Turn the unit off.
9. Mount the top cover on its place.